

"DRESSING ROOMS"

- SHOWER
- RESTROOM
- SINK
- LOCKER
- MIRROR
- LAUNDRY ROOM

SOUTH

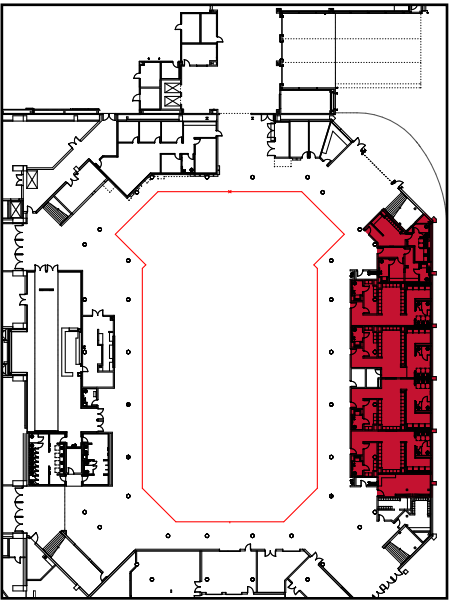

Star Dressing Room 1

Star Dressing Room 2

Locker Room A

Locker Room B

Locker Room C

Locker Room D

Laundry Room

WEST

EAST

North

